



WISE-5800

User-defined I/O & Data Logger Module

I/O Expansion & Data Logger Module

Features

- Built-in Web Server for IF-THEN-ELSE rule setting
- Built-in IF-THEN-ELSE rule engine for logic operation
- No more programming. Just click and get done!
- Support IO, Counter, Timer, Schedule, Email, Recipe operations
- Data logger and data files send back function supported
- Modbus TCP Protocol for SCADA Software Seamless Integration
- 10/100 Base-TX Ethernet
- Support XW-Board
- Support I-7000 Remote I/O Modules(Up to 16)
- SNTP Time Synchronization Supported



Introduction

WISE (Web Inside, Smart Engine) is a product series developed that functions as control units for use in remote logic control and monitoring in various industrial applications. WISE offers a user-friendly and intuitive web site interface that allows users to implement IF-THEN-ELSE control logic on controllers just a few clicks away; no programming is required. With its powerful and easy-to-use features, it will minimize the learning curve, shorten time to market and dramatically reduce the effort and cost spent on system development.

WISE-5800 supports an I/O expansion bus to implement various I/O functions such as D/I, D/O, A/D and D/A according to the XW-Board. In addition, WISE-5800 also support I-7000 remote I/O modules. Based on the variety I/O module of I-7000, WISE-5800 can provide user more flexibility in application field.

WISE-5800 supports Modbus/TCP protocol to make seamless integration with SCADA software available. It include all advantages which WISE series controllers can provide. In addition, WISE-5800 provide data logger function with microSD card, it can record I/O channel value by event trigger or regular time period. The data files can be sent back by Email or FTP. All setting can be completed through browser.

Applications

Building Automation, Factory Automation, Machine Automation, Remote Maintenance, Remote diagnosis and Testing Equipment, etc.

Specifications

Models	WISE-5800
CPU Module	
CPU	16-bit CPU
SRAM	768 KB
Flash	512 KB
EEPROM	16 KB
NVRAM	31 Bytes
microSD Expansion	Yes, can support 1 or 2 GB microSD
RTC (Real Time Clock)	RTC Provide seconds, minutes, hours, date of week/month; month and year
Watchdog Timers	Yes (0.8 second)
Communication Ports	
Ethernet	RJ-45 x 1, 10/100 Base-TX (Auto-negotiating, Auto MDI/MDI-X, LED indicators)
COM 1	RS-232 (Reserved, Unsupported by WISE firmware)
COM 2	RS-485 (D2+, D2-), self-tuner ASIC inside, non-isolated, Speed : 115200 bps max.
LED Indicator	
System LED	Yes (Red)
Ethernet Link LED	Yes (Green : Ethernet link detected, Flashing Green : Ethernet packet received)
LED Display	-
Hardware Expansion	
I/O Expansion Bus	Yes
Mechanical	
Dimensions (W x H x D)	91 mm x 123 mm x 52 mm
Installation	DIN-Rail
Environmental	
Operating Temperature	-25 ~ +75 °C
Storage Temperature	-40 ~ +80 °C
Ambient Relative Humidity	5 ~ 90% RH (non-condensing)
Power	
Protection	Power reverse polarity protection
Frame Ground	Yes (for ESD Protection)
Input Range	+12 ~ +48 Vdc
Redundant Power Input	Yes
Power Consumption	2.0 W

Software Specifications

Functions	
Rule Configuration Website	Access Web server on WISE controllers to edit and upload logic rules through web browser.
36 IF-THEN-ELSE Logic Rules	3 IF conditions with AND or OR operators 3 THEN actions and 3 ELSE actions
48 Internal Registers	Hold temporary variables and read/write data via Modbus TCP address.
12 Timers	Delay / Timing functions.
12 Schedules	Setup prescheduled routine tasks.
12 Emails	Send Email messages to pre-set Email receivers.
12 CGI Commands	Send pre-set CGI commands.
12 Recipes	Set up THEN/ELSE action groups.
Data Logger	Set up the Data Logger configuration, include the data record format, and data file sending operation.
Modbus TCP Protocol	Real time control and monitoring I/O channels and system status of controllers via SCADA software.

IF Conditions	
DI Channel	ON - OFF - ON to OFF - OFF to ON - Change
AI Channel	= > < > > = < = (value)
Internal Register	
DI Counter	= > < > > = < = (value) - Change
Timer	Timeout - Not Timeout
Schedule	In Range - Out of Range
Rule Status	Enable - Disable

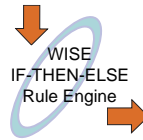

THEN / ELSE Actions	
DO Channel	ON - OFF - Pulse Output (Just for XW-Board)
AO Channel	Change the value
Internal Register	
DI Counter	Reset
Timer	Start - Reset
Schedule	Enable - Disable
Email	Send
CGI Commands	Send
Recipe	Execute
Data Logger	Start - Stop - One-Time Log
Rule Status	Enable - Disable

Appearance

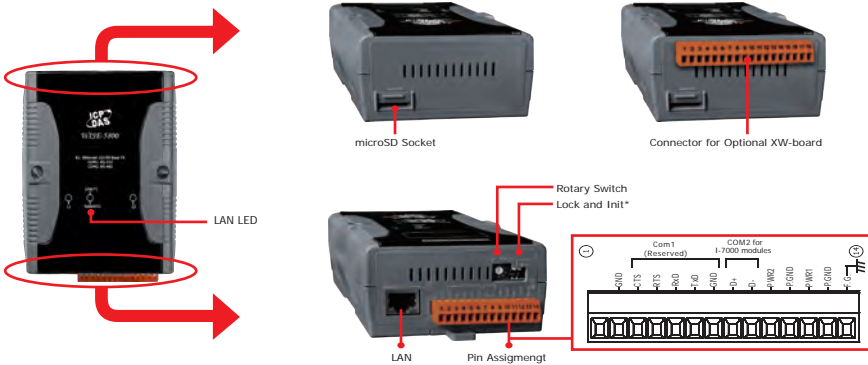

Dimension(Units: mm)

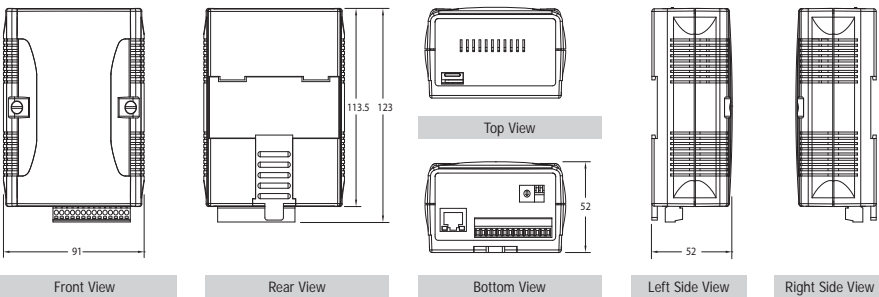

Ordering Information

WISE-5800	User-defined I/O & Data Logger Module
-----------	---------------------------------------

Accessories

NS-205 CR	Unmanaged 5-Port Industrial Ethernet Switch (RoHS)
MDR-20-24 CR	24V/1A, 24 W Power Supply with DIN-Rail Mounting (RoHS)
DIN-KA52F CR	24V/1.04A, 25 W Power Supply with DIN-Rail Mounting (RoHS)
3LMSD-2000 CR	2 GB microSD card (RoHS)